

HS-550 Vibration Module

Acceleration Power Supply and Signal Amplifier

Key Features

- Provides power for constant current accelerometers
- 3 Gain Settings
- TDX OK Indicator
- DIN Rail Mounted

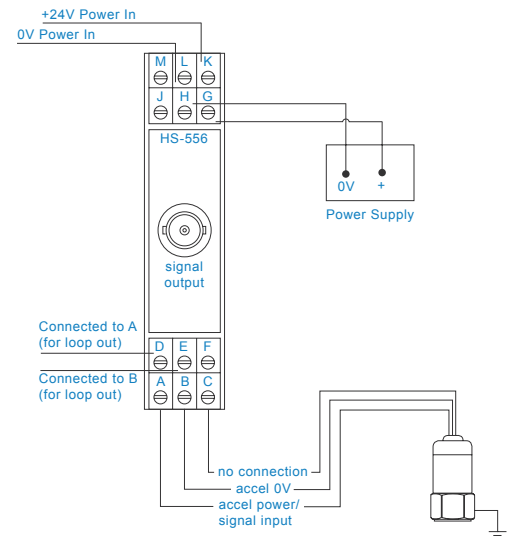

Technical Performance

| | |
|--------------------------------|--|
| Power Input | 24 VDC $\pm 10\%$ @ 20 mA max. |
| Accelerometer Driving Voltage | 22.5 VDC |
| Accelerometer Constant Current | 4 mA or 10 mA selectable via link |
| Maximum Output | ± 9 V at x1 gain ± 5 V at 10 gain ± 4.5 V at x100 gain |
| Voltage Gain | x1, x10, x100 selectable via DIL switch |

Mechanical

| | |
|----------------|--------------------------|
| Case Material | Plastic |
| Mounting | DIN Rail TS35 (Top Hat) |
| Dimensions | 100 x 75 x 24 mm (HxDxW) |
| Connections | Screw Clamp |
| Conductor Size | 0.5 to 4.0 mm |
| Weight | 76 gms (nom) |

Electrical

| | |
|----------------------------|--|
| Frequency Response | 1 Hz to 120 KHz -3db at x1 gain |
| | 1 Hz to 50 KHz -3db at x10 gain |
| Broadband Noise (1-10 KHz) | 1 Hz to 10 KHz -3db at 100 gain |
| | 70 μ V rms at x1 gain |
| | 650 μ V rms at x10 gain 3 mV rms at x100 gain |
| Fault Indication | Red LED 5 V > Vbias > 15 V |

Environmental

| | |
|--------------------------------|----------------|
| Operating Temperature Range | 0 to 55 °C |
| EMC | EN61326-1:2013 |
| Installation Category (IEC664) | II |
| Equipment Class (IEC536) | III |

We reserve the right to alter the specification of this product without prior notice



Vertriebspartner für Deutschland



beta SENSORIK GmbH
Hummendorfer Straße 74 · 96317 Kronach
Telefon 09261 96607-0 · Fax 09261 96607-11
briefkasten@betasensorik.de · www.betasensorik.de



TS054.4